

Aranui 5

YOUR HOME IN THE ISLANDS





Among the many ships CRUISING IN THE SOUTH PACIFIC, THE ARANUI 5 IS UNIQUE IN EVERY WAY.

In the Island Tradition, our gracious staff continues the warmth and intimacy of the previous *Aranui* ships, welcoming passengers as part of their extended family.

You will quickly meet your fellow adventurers, and with four bars and a lounge, there is plenty of space to relax, get acquainted and share new discoveries.

The *Aranui 5* was designed to accommodate 254 passengers, with 29 spacious Suites, 31 Deluxe and Superior Deluxe Staterooms, with balconies; 3 Junior Suites with or without balconies; and 40 State-rooms, all beautifully appointed with your well-being in mind. For the more adventurous, the shared space in C Class will accommodate 24 passengers.

The large, family-style dining room offers excellent French and Polynesian cuisine. Dress is island casual, no tux, just a fragrant tiare (flower) behind your ear. Air conditioning will keep you comfortable in the cabin and public areas. There are two passenger elevators.

Enjoy a refreshing dip in the pool, stretch your muscles in the gym, relax in the spa or take in ocean breezes on deck. Time passes quickly as you learn about the Marquesas from our guest lecturers, or, perfect your dance or hat-weaving skills. In the library, you can read how Melville, Stevenson and Heyerdahl describe these alluring islands as you experience them firsthand. Visit the boutique to discover a wealth of treasures, both local and imported.



Suites & CABINS

PRESIDENTIAL SUITE

Consisting of 3 individual rooms, approximately 440 sq. ft. of interior space and a 130 sq. ft. private balcony, this exterior cabin offers a separate bedroom with a king size bed, a sitting room with a sofa bed, a lounge with a built-in bar, 2 bathrooms with shower and hair dryer, a walk-in closet, refrigerator and safe.



ROYAL SUITE

From approximately 240 sq. ft. of interior space and a 100 sq. ft. private corner balcony, this exterior cabin offers a bedroom with a king size bed or twin beds and a sitting room with a sofa bed, divided by a decorative filigree screen, a bathroom with shower and hair dryer, refrigerator and safe.



PREMIUM SUITE

From approximately 200 sq. ft. of interior space and a 45 sq. ft. private balcony, this exterior cabin offers a bedroom with a king size bed or twin beds and a sitting room with a sofa bed, divided by a decorative filigree screen, a bathroom with shower and hair dryer, refrigerator and safe.



JUNIOR SUITE

From approximately 160 sq. ft. to 200 sq. ft. of interior space with or without balcony, this exterior cabin offers a bedroom with a king size bed or twin beds, a bathroom with shower and hair dryer, refrigerator and safe.



SUPERIOR DELUXE

From approximately 160 sq. ft. of interior space and a 45 sq. ft. private balcony, this exterior cabin offers a bedroom with a king size bed or twin beds, a bathroom with shower and hair dryer, refrigerator and safe.



DELUXE

From approximately 140 sq. ft. of interior space and a 45 sq. ft. private balcony, this exterior cabin offers a bedroom with a king size bed or twin beds, a bathroom with shower and hair dryer, refrigerator and safe.



STANDARD STATEROOM

From approximately 120 sq. ft. of interior space and a porthole, this exterior cabin offers either, a king size or two single beds, a bathroom with shower and hair dryer. Single, with approximately 100 sq. ft. of interior space and a single bed, and four-passenger staterooms, with approximately 180 sq. ft., a queen size bed and two single bunk beds are also available.



CLASS C

Dormitory style accommodations, this category offers approximately 285 sq. ft. of shared interior space with four lower and four upper berths, a sitting area, two bathrooms with shower and hair dryer. Four passenger units with approximately 135 sq. ft. of shared interior space are also available.



Deck PLAN

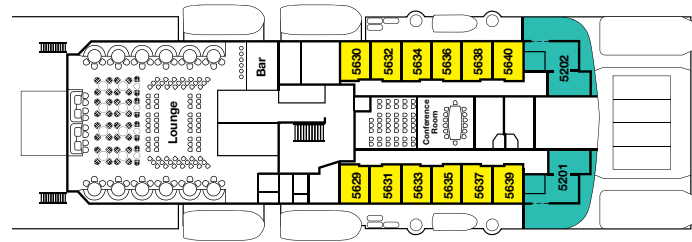

BOAT DECK-5

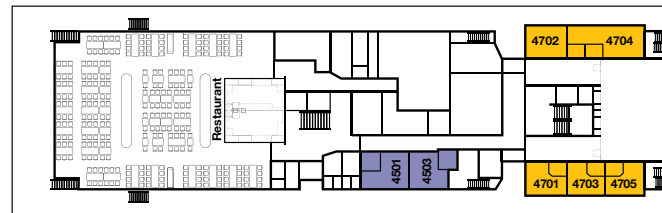

UPPER DECK-4

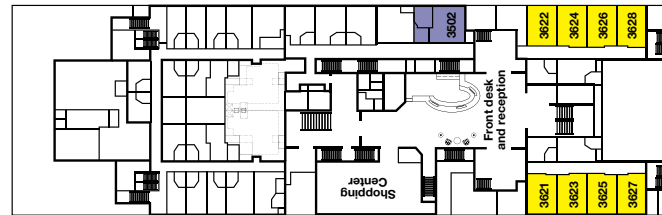

MAIN DECK-3

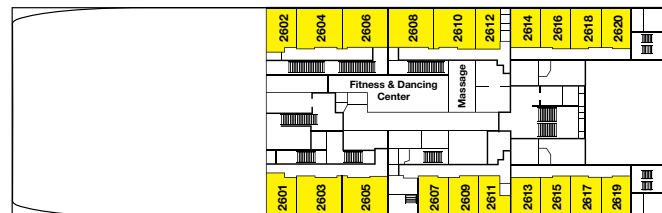

LOWER DECK-2

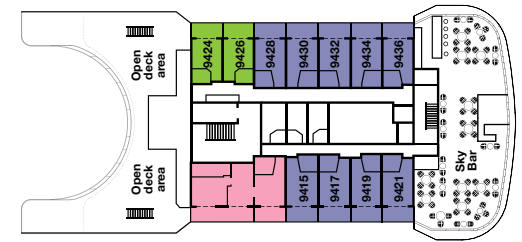

SKY DECK-9

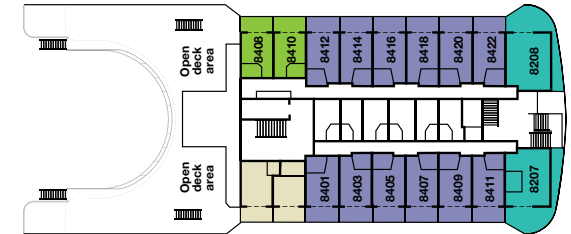

SUN DECK-8

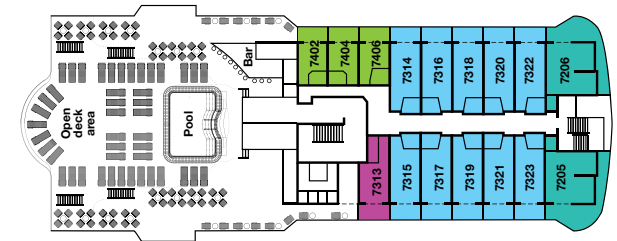



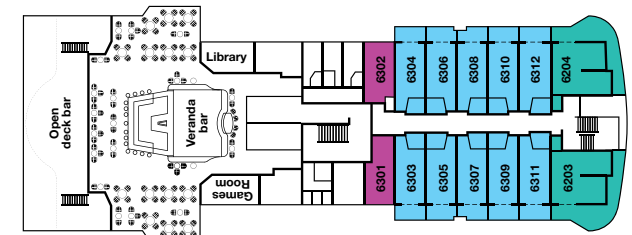





POOL DECK-7



VERANDA DECK-6

Specifications

	Presidential Suite
	Royal Suite
	Premium Suite
	Junior Suite with or without Balcony
	Superior Deluxe
	Deluxe
	Stateroom
	Class C

FAST FACTS:

Length: 410 feet
Breadth: 85 feet
Cruising Speed: 15 knots
Draft: 17 feet

Deadweight: 3200 metric tons
Capacity: 254 passengers – 103 cabins
Crew: 103

Ship Builder: Huanghai Shipbuilding Co., Ltd of China
Naval Architect: Shanghai Merchant Ship Design & Research Institute (SDARI) of China
Ship Designer: Shiptec of Hamburg in cooperation with Team 7 of San Francisco
Interior Designer: Team 7 of San Francisco

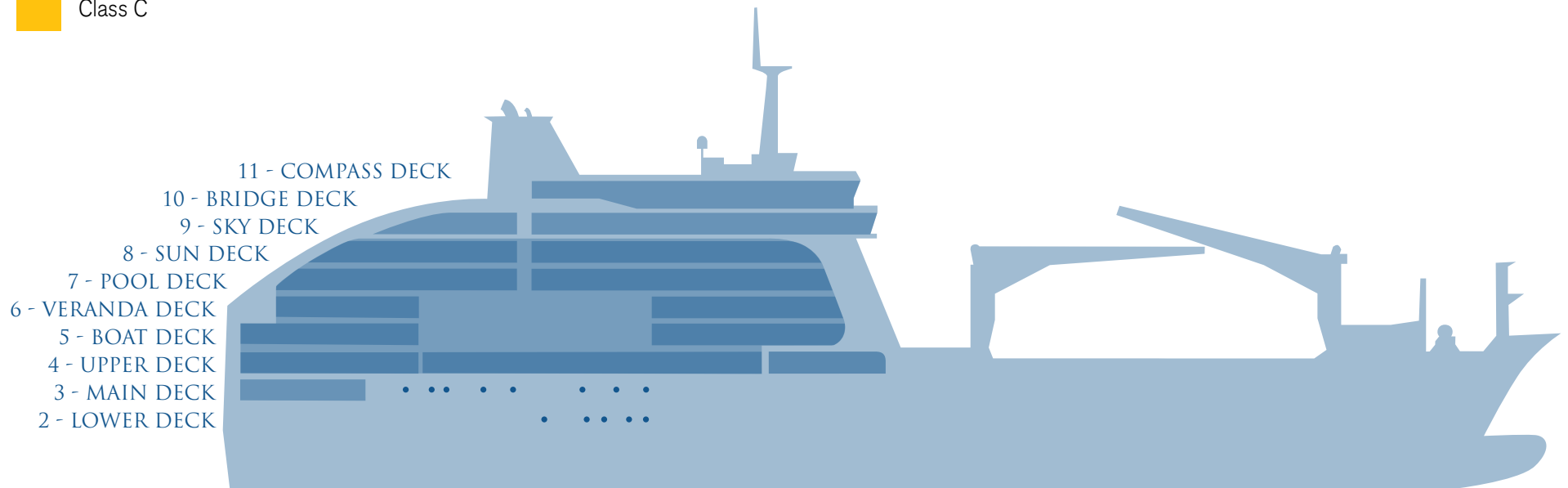

Ship's Information

FOOD

Meals are served in an informal, family-style setting in our dining facilities. Special consideration for medically prescribed diets, must be requested at the time of booking or not less than three weeks in advance of sailing date.

LOCAL CURRENCY

The unit of exchange is the French Pacific Franc (XPF).

LOCAL TIME

The Marquesas are half an hour ahead of Tahiti. Thus, when it's noon in Tahiti, it's 12:30pm in the Marquesas.

CLIMATE & PACKING SUGGESTIONS

Clothing which is informal, comfortable and easily washable is most practical aboard the ship. In addition to shorts, jeans or slacks, T-shirts and a bathing suit, a rain poncho or coat and warm sweatshirt or light sweater for chilly evenings are recommended. Comfortable shoes are essential for walking ashore over coral reefs. Tennis shoes or sandals are recommended. For women, the native pareo, made of colorful fabric which can be wrapped in a variety of styles, is a versatile choice for both casual and festive occasions.

SPA TREATMENTS

The Aranui Spa offers a variety of treatments by our fully trained wellness and massage therapist. Pamper yourself with a facial, body scrub and massages using the traditional oils of French Polynesia. Treat yourself to a manicure or pedicure or a relaxing foot massage—perfect after a day exploring.

SHIP'S BOUTIQUE

The ship's boutique sells a variety of supplies including mosquito repellent, sundries, clothing, and local souvenirs.

ELECTRICAL CURRENT

Each cabin is equipped with 220 volt, 50 cycle AC (European-style outlet).

INTERNET

Wifi is available during the voyage, using your own devices, in most public areas throughout the ship. Provided by satellite service, the connection may not be as reliable as land broadband, but it is adequate for checking and sending emails. A log-in code can be purchased from the boutique.

EMERGENCY TELEPHONE

In an emergency, it is possible to place telephone calls through our shipboard communications and to contact the vessel through CPTM's office in Tahiti.

LAUNDRY

Washing and drying machines are available on board; dry cleaning is not available.

MEDICAL

There is a doctor or physician on board the vessel. If any person has, or is suffering from a serious ailment or condition, they should seek the advice and consent of their personal physician prior to embarking on the vessel. The right is reserved to refuse passage to anyone in such a state of health or physical condition as to be unfit to travel or whose condition, for whatever reason, might be dangerous to the individual or other passengers.

SHORE VISITS

Visits ashore are limited to the time required by cargo operators and port restrictions. Port time may range from just a few hours to a day or more. While shore excursions with supplement may be available at some ports of call, Compagnie Polynésienne de Transport Maritime (CPTM) neither owns nor operates nor exercises any control over shore excursions arranged at any port of call. The company, its agents and employees do not assume any responsibility in connection with the operations of said programs. The company accepts no responsibility of liability for the failure of any operator to perform any said program and/or for any injury, damage or loss however caused or arising therefrom.

TRAVEL FUNDS

Travelers checks and credit cards may be used to pay for shipboard expenses. American Express, Visa and MasterCard will be accepted. Travelers checks can be cashed on board, personal checks cannot. Euro, USD, AUD, NZD and CAD currency notes can also be exchanged.

VALUABLES

Electronic lock boxes are available on board, however CPTM cannot accept custody or responsibility for passenger's money or other valuables while aboard the vessel.

